



OK series motor adapt the advanced Geroler gear set design with shaft distribution flow, which can automatically compensate in operating with high pressure, provide reliable and smooth operation, high efficiency and long life.

- *Advanced manufacturing devices for the Gerolor gear set, which use low pressure of start-up, provide smooth, reliable operation and high efficiency.
- *Shaft seal can bear high pressure of back and the motor can be used in parallel or in series.
- *Special design in the driver-linker and prolong operating life
- *Special design for distribution system can meet the requirement of low noise of unit.
- *Compact volume and easy installation

Technical data for OK with 25 and 1 in and 1 in splined and 28.56 tapered shaft

Code	Displacement [cm/rev]	Max.Speed [rpm]	Max.Torque [Nm]		Max.output [kW]		Max.pressure [MPa]		Max.Oil Flow[L/min]
		cont.	cont.	int.	cont.	int.	cont.	int.	cont.
OK 36	36	1111	66	83	9	10.4	14	17.5	40
OK 50	51.7	780	100	129	9	10.4	14	17.5	40
OK 80	81.5	744	158	196	10.4	12.6	14	17.5	60
OK 100	102	595	200	242	10.8	12.8	14	17.5	60
OK 125	127.2	480	248	298	10.8	12.5	14	17.5	60
OK 160	157.2	382	315	384	10.4	11.5	14	17.5	60
OK 200	194.5	301	339	419	8.8	10.2	12.5	15.5	60
OK 250	253.3	238	403	474	8.1	9.4	11	14	60
OK 315	317.5	191	398	498	7.4	7.8	9	12.5	60
OK 375	381.4	162	373	466	6.2	7.1	7.5	9	60

Type	H	L
OK36	7	105
OK50	10	108
OK80	16	114
OK100	20	118
OK125	25	123
OK160	30.5	128.5
OK200	38.1	136
OK250	50	148
OK315	62	160
OK375	74	172

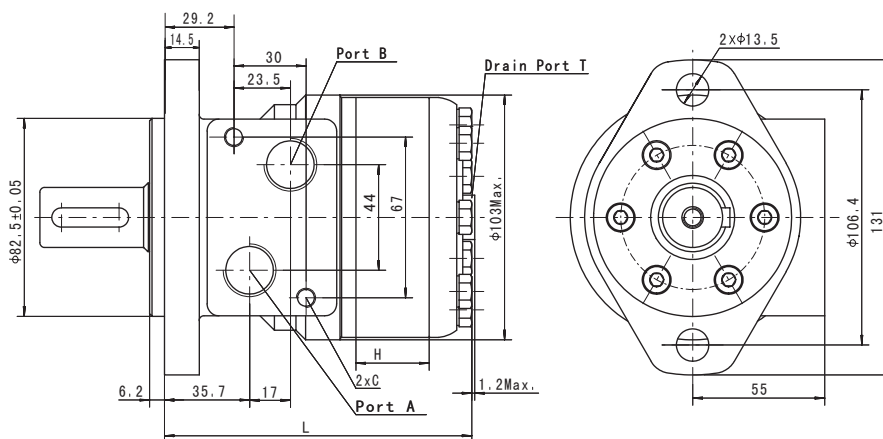

Code Mounting	D (depth)	M (depth)	S (depth)	P (depth)	R (depth)
P(A,B)	G1/2 (15)	M22 x 1.5 (15)	7/8-14 O-ring (16.7)	1/2-14NPTF (15)	PT(RC)1/2 (15)
C	4-M8 (13)	4-M8 (13)	4-5/16-18UNC(13)	4-5/16-18UNC(13)	4-M8 (13)
T	G1/4 (12)	M14 x 1.5 (12)	7/16-20UNF (12)	7/16-20UNF (12)	PT(RC)1/4 (9.7)

Direction of shaft rotation: Standard
 When facing shaft end of motor, shaft to rotate:
 Clockwise when port "A" is pressurized.
 Counter-clockwise when port "B" is pressurized.

SHAFT EXTENSIONS FOR OK MOTORS

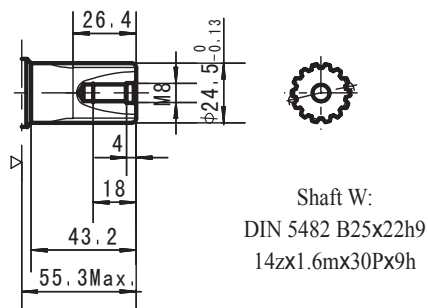
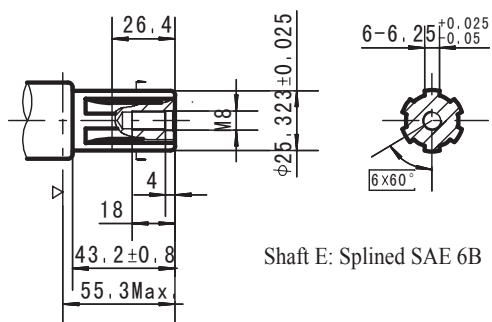
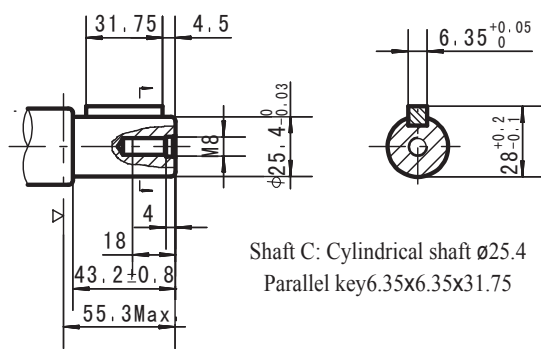
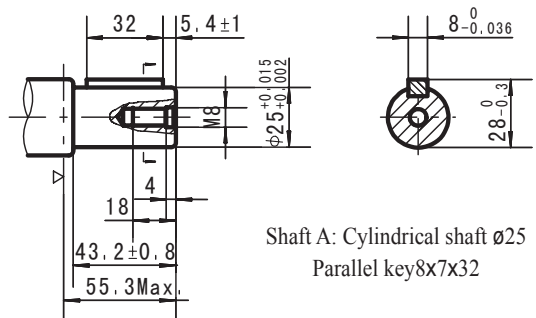

▷ Motor Mounting Surface

Order Information

<div>OK<div>1<div></div></div><div>2<div></div></div><div>3<div></div></div><div>4<div></div></div><div>5<div></div></div><div>6<div></div></div><div>7<div></div></div><div>8<div></div></div></div>												
Pos.1	2	3		4		5	6	7	8			
Code	Disp.	Flange		Output Shaft		Ports and Drain Port	Rotation Direction	Paint	Unusually Function			
Omit	36	2-Ø13.5 Rhomb-flange , pilot Ø82.5×6.2		A Shaft Ø25 , parallel key 8×7×32 C Shaft Ø25.4 , parallel key 6.35×6.35×31.75 E Shaft Ø25.4, splined key SEA 6B W Shaft Ø24.5, splined B25X22 T Cone shaft Ø28.56, parallel key B5×5×14		D	G1/2	Manifold 4×M8, G1/4	Omit Standard Opposite R	No paint Blue Black Silver grey	Omit F O	Standard Free Running No case drain
	50					M	M22×1.5	Manifold4×M8,M14×1.5				
	80					S	7/8-14	O-ring manifold				
	100					P	4×5/16-18UNC,7/16-20UNF	1/2-14NPTF manifold				
	125					R	4×5/16-18UNC,7/16-20UNF	PT(Rc)1/2 manifold 4×M8,PT(Rc)1/4				
	160											
	200											
	250											
	315											
	375											

专业做液压-专注做精品

PROFESSIONAL ON HYDRAULIC- FOCUS ON HIGH QUALITY

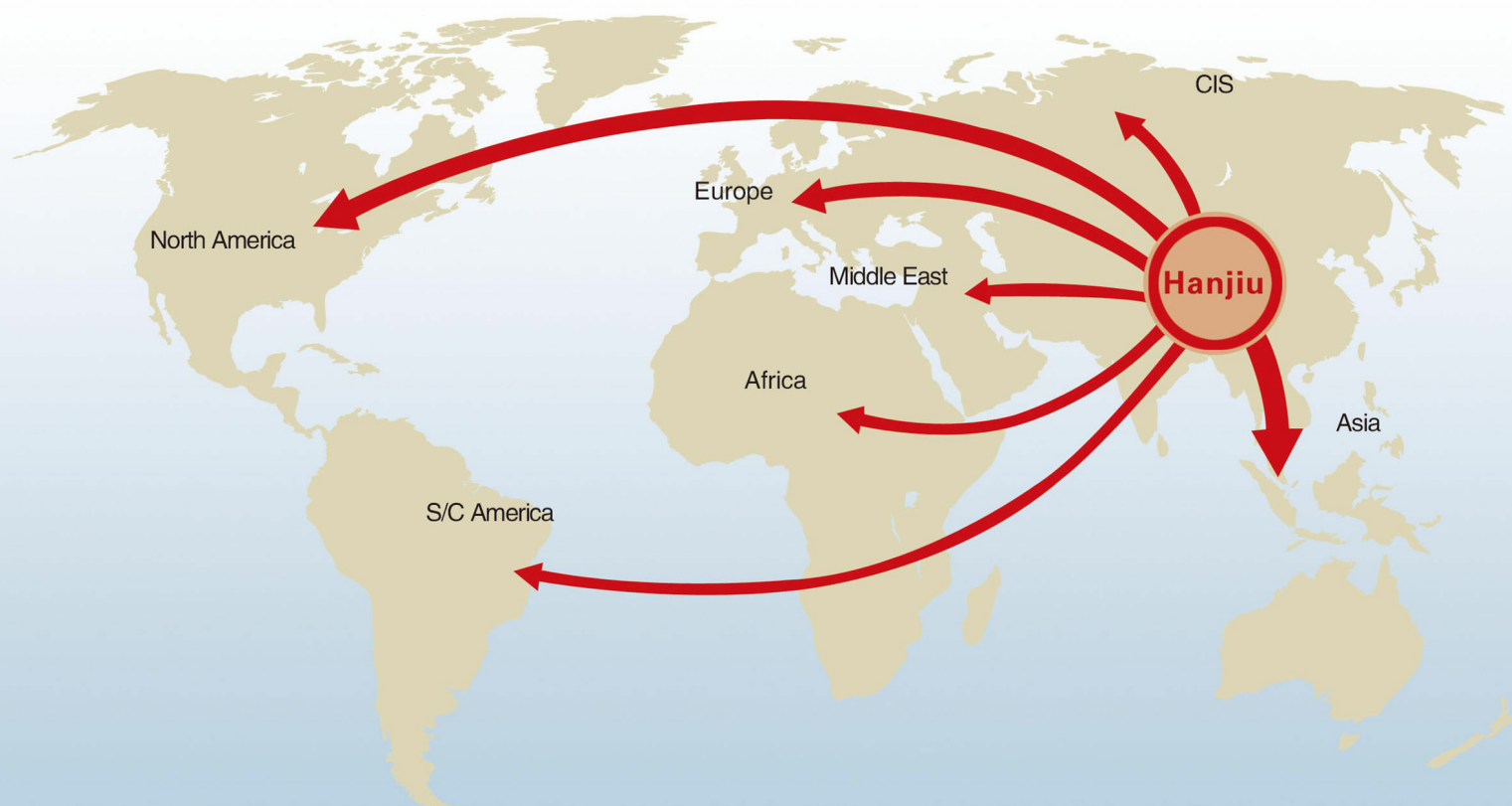

石家庄寒九科技有限公司

地址：中国河北石家庄友谊北大街398号

电话：+86 (311) 68123061

传真：+86 (10) - 80115555-568844

邮编：050000

网址：www.hjhydraulic.com

邮箱：manager@sjzhjism.com

SHIJIAZHUANG HANJIU TECHNOLOGY CO.,LTD.

Add: No. 398 Youyi Street, Shijiazhuang, Hebei, China

Tel: +86 (311) 68123061

Fax: +86 (10) - 80115555-568844

Post code: 050000

Web: www.hjhydraulic.com

Email: manager@sjzhjism.com